



# Reversible Beaded PVC Planking Installation Guide

## Tools



Level / Tape Measure / Square Angle / Adhesive Gun  
Saw / Hammer / Nail / Nail Driver

## Planning

Inteplast Beaded PVC Planking is reversible with different bead to bead width for project preference. It can be installed with Inteplast Baseboard, Chair Rail, or other similar mouldings that are sold separately. For easy installation, use construction adhesive. For better holding strength, use 1" finishing nails.

## 1. Install Beaded PVC Planking and Baseboard

Beaded PVC Planking may be installed behind or on top of the baseboards. Start at an inside corner and work your way out. Insert each plank into the top groove of baseboard. Apply adhesive in a zigzag pattern before installing. Keep the grooved edge toward the starting corner and the tongue edges toward your work direction. Make sure all planks have been applied to the baseboard correctly and check to see that all planks are leveled against the wall. Allow space between planks for expansion and contraction.

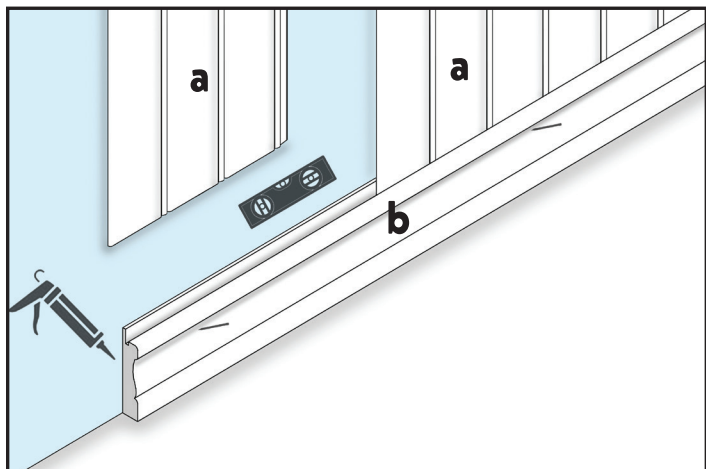
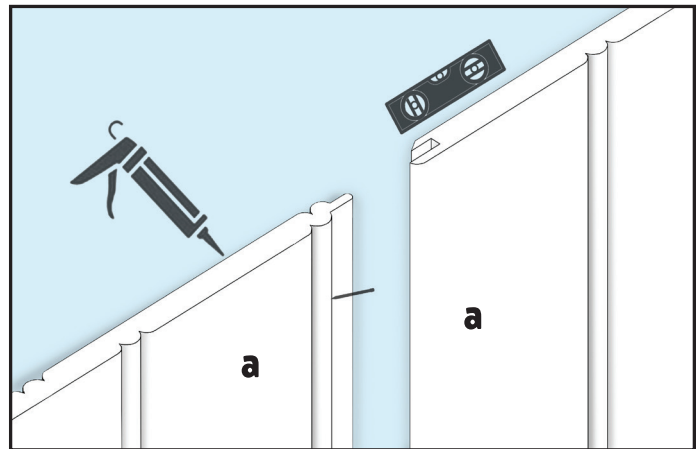
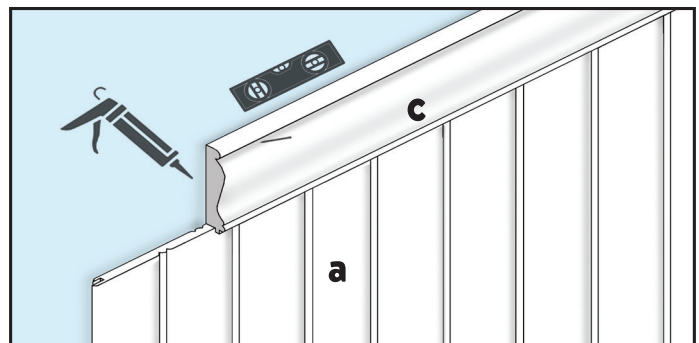

Diagram legend:  
**a:Planking b:Baseboard c:Chair Rail**



Nailing is optional for better holding strength. Angle and drive nails within 1/4" of the surface and then use a nail set. Measure and fit the next plank carefully. The last plank may have to be trimmed to fit into a corner. Miter cut and join Inteplast Baseboard and Chair Rail mouldings with PVC cement if joint is needed.

## 2. Add Chair Rail



Apply Inteplast Chair Rail on top of Beaded PVC Planking. Inteplast Chair Rail is pre-grooved at the bottom and fits over the Planking. Apply finishing nails for better holding strength. Fill in any gaps with caulk or wood putty.

## Maintenance

Regular cleaning with a damp cloth will leave Beaded PVC Planking looking just like new. If the product has been painted, make sure to follow the paint manufacturer's instructions for maintaining the finish.